

PEP Ergo Slab Props

High load-bearing capacity with low self-weight



PERI PEP Ergo

The new generation of slab props

With the PEP Ergo, PERI presents a new generation of props which are characterised by a further increase in load-bearing capacity and many trend-setting detailed solutions with low individual component weights.

The design of the PEP Ergo props is in dependence on the European standard specifications.

■ High load-bearing capacity = fewer props

The capacity factor – defined as the load-bearing capacity to prop weight ratio – can reach up to 70% above the values of comparable slab props.

PERI PEP Ergo props fully comply with Load Class B resp. D of EN 1065. The max. bearing capacity is 35 kN.



The PEP Ergo B-300 weighs only 13.9 kg and carries as maximum 30 kN.

■ **Large adjustment range = fast forming**

Due to the large adjustment range of 12 cm, the G-hook only seldom needs to be re-positioned. In addition, the proven, integrated measuring scale in the form of stamped numbers on the inner tube ensures efficient and error-free working on the construction site.

■ **Low risk of injury = safe forming**

The integrated anti-pinch feature with a safety clearance of 10 cm at the top end protects the user against injury. The integrated fail-safe device prevents the inner tube from unintentionally falling out.

■ **Simple logistics**

Robust, always visible and easily readable stamped indicia on the head and base plates ensure fast and safe identification of the stored props also within the stacking pallets.

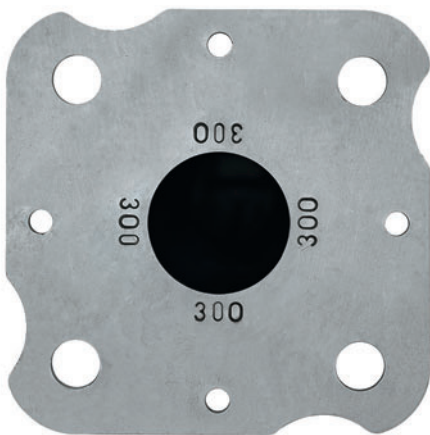

The length stamping on the PEP Ergo props is clearly readable.

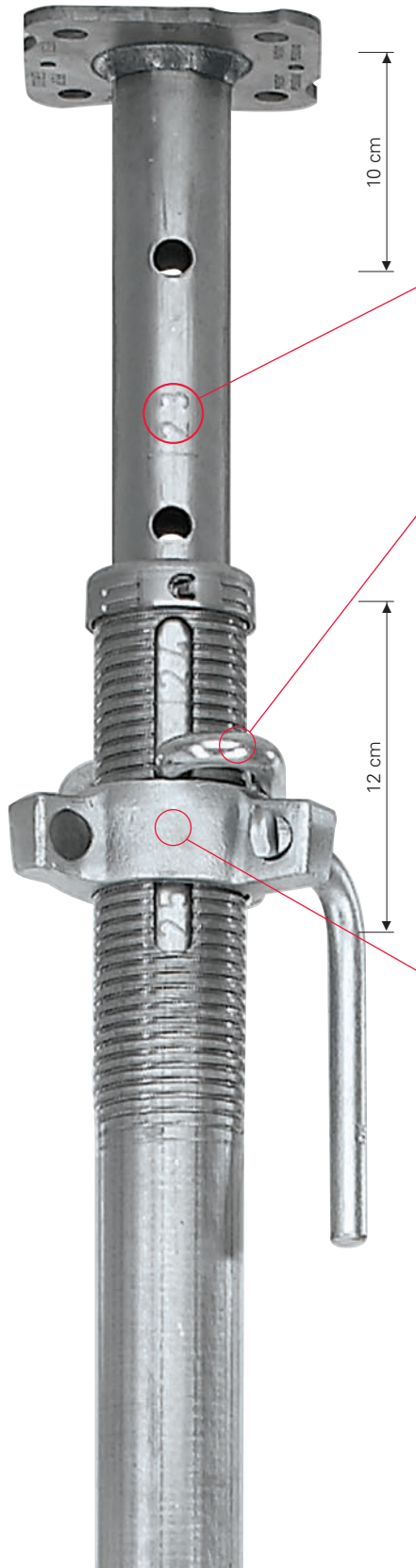

Low risk of injury

The integrated 10 cm safety clearance protects against injuries.

Stamped measuring scale

For faster prop length adjustment. Stamped numbers on the inner tube show the overall length in dm, readable at the end of the outer tube.

Good handling

The G-hook is ergonomically formed and can be securely clamped.

Generous adjustment range

The large adjustment range of 12 cm makes frequent pin adjustment unnecessary.

High grade three-wing nut.

High-quality nut with hardened bearing surface and double-thread for easy loosening even under full loads.

PERI PEP Ergo

Well-developed features for faster forming

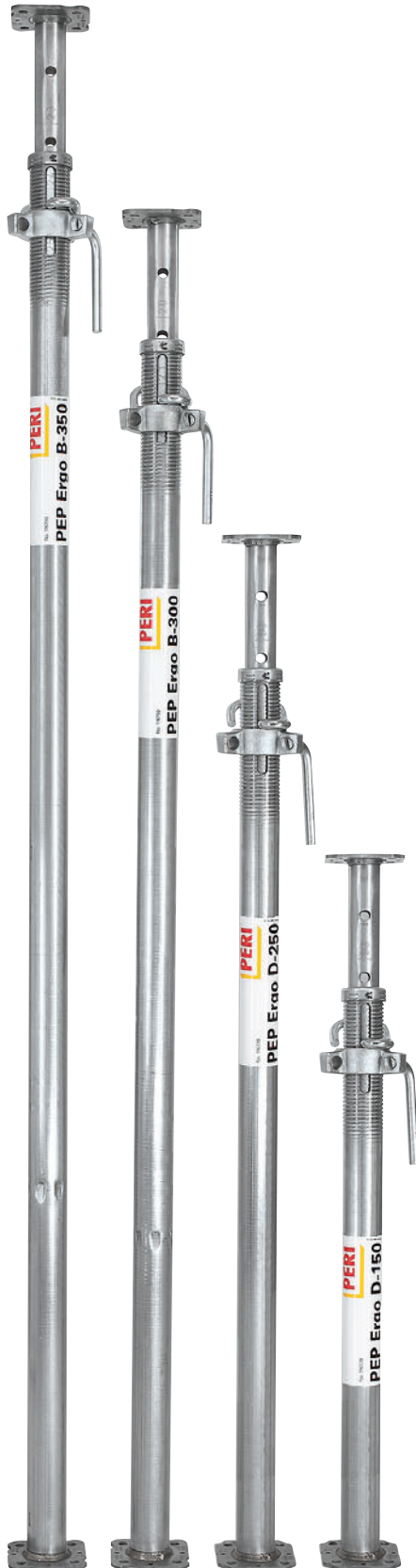

■ Long service life

The complete galvanisation of all surfaces guarantees a long service life. The new closing nut additionally provides a unique repair capability. This allows defective inner and outer tubes to be easily replaced.

■ Assembly of accessories

Naturally, the use of all PERI props heads (supports) is guaranteed and is also usable on both sides through the identical end plates on the inner and outer tubes.



GRIDFLEX Prophead GFH fitted to the inner tube.



MULTIFLEX Crosshead fitted to the outer tube.

■ **New adjusting nut**

The form of the lowering nut dictates the direction of lowering the load and ensures that lowering is carefully carried out also under maximum load.



The adjusting nut has a generously-sized hammer striking face and determines the impact direction.



PERI Ergo props can be easily adjusted with the help of the captive handgrip.

■ **Assembly aids**

The PERI Ergo tripod or the PERI PRK frame are used as assembly aids.



The PERI Ergo tripod and the PERI PRK frame are used as assembly aids.

Slab Props

PEP Ergo

Permissible Prop Load [kN]

Extension Length [m]	PEP Ergo D-150 L = 0,96 – 1,50 m		PEP Ergo D-250 L = 1,47 – 2,50 m		PEP Ergo B-300 L = 1,97 – 3,00 m		PEP Ergo B-350 L = 2,25 – 3,50 m	
	Outer Tube Bottom	Inner Tube Bottom	Outer Tube Bottom	Inner Tube Bottom	Outer Tube Bottom	Inner Tube Bottom	Outer Tube Bottom	Inner Tube Bottom
1,00	30,0	30,0						
1,10	30,0	30,0						
1,20	30,0	30,0						
1,30	30,0	30,0						
1,40	28,4	30,0						
1,50	26,4	30,0	35,0	35,0				
1,60			35,0	35,0				
1,70			32,8	35,0				
1,80			30,7	35,0				
1,90			29,1	35,0				
2,00			28,1	35,0	30,0	30,0		
2,10			27,2	35,0	29,8	30,0		
2,20			26,4	34,0	27,0	30,0		
2,30			25,7	32,3	24,6	30,0	30,0	28,6
2,40			24,2	29,4	23,0	30,0	28,6	28,6
2,50			22,4	26,2	21,4	30,0	25,5	28,6
2,60					20,3	29,5	23,1	28,3
2,70					19,3	27,4	21,2	28,0
2,80					18,2	24,8	19,8	27,4
2,90					16,9	22,2	18,6	26,0
3,00					15,6	20,2	17,5	24,4
3,10							16,3	22,7
3,20							15,2	20,8
3,30							14,2	19,0
3,40							13,2	17,4
3,50							12,4	15,7

Note:

- The load-bearing capacity of the PERI PEP Ergo D-150 and PEP Ergo D-250 props corresponds to Class D of DIN EN 1065.
- The PEP Ergo D-250 prop additionally corresponds to Class B of DIN EN 1065.
- The load-bearing capacity of the PERI PEP Ergo B-300 and PEP Ergo B-350 props corresponds to Class B of DIN EN 1065.
- Construction Approval No. Z-8.331-934 by the Deutsches Institut für Bautechnik.
- All values are Service Loads.

PEP Ergo Slab Props



Item no. Weight kg

117230	9,100	PEP Ergo Slab Props
116770	13,000	PEP Ergo D-150 Slab Prop
116780	13,900	PEP Ergo D-250 Slab Prop
116790	15,500	PEP Ergo B-300 Slab Prop
		PEP Ergo B-350 Slab Prop

Steel slab prop.

min. L	max. L
960	1500
1470	2500
1970	3000
2250	3500

Note

Permissible load: see PERI Design Tables.

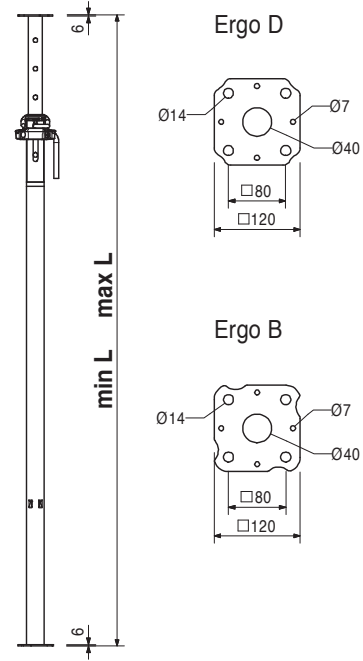
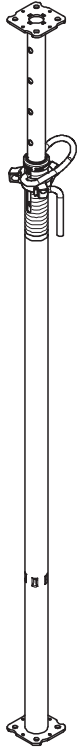

107152 5,810

Tripod PEP Ergo, galv.

Assembly aid for PEP Ergo slab props with Ø 44 – 64 mm.

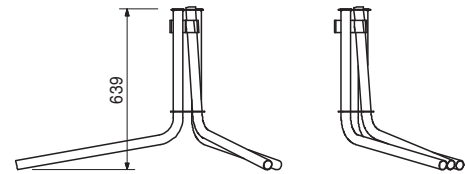
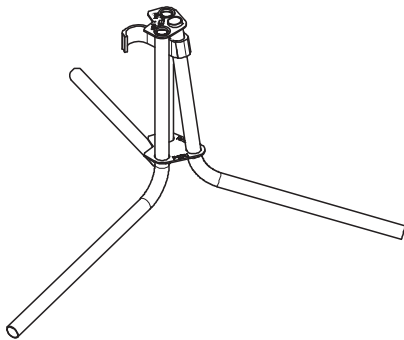

PEP Ergo Slab Props



Item no.	Weight kg
111811	13,700
111812	13,900
112813	15,900
112814	17,800
111813	19,200
111814	20,100

PEP Frames PRK Steel
PEP Frame PRK 62.5
PEP Frame PRK 75
PEP Frame PRK 100
PEP Frame PRK 120
PEP Frame PRK 137.5
PEP Frame PRK 150

L	X
723	625
848	750
1098	1000
1298	1200
1473	1375
1598	1500

Bracing frame for PEP slab props. With captive wedge coupling.

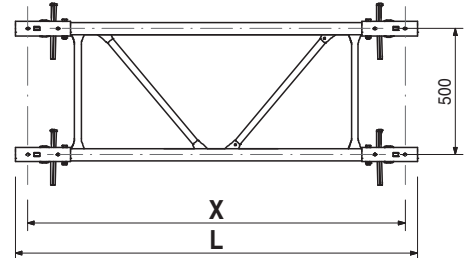
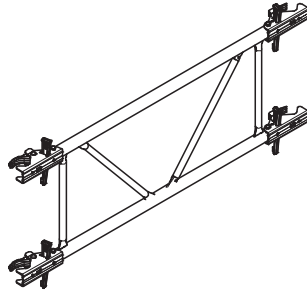

115980	14,700
112718	15,300
111815	15,400
112788	15,600
111816	16,200
111817	16,300
111818	17,700
111819	18,600

PEP Frames PRK
PEP Frame PRK 180
PEP Frame PRK 200
PEP Frame PRK 201.5
PEP Frame PRK 210
PEP Frame PRK 225
PEP Frame PRK 230
PEP Frame PRK 266
PEP Frame PRK 296

L	X
1098	1800
2098	2000
2113	2015
2198	2100
2348	2250
2398	2300
2758	2660
3058	2960

Bracing frame for PEP slab props. With captive wedge coupling.

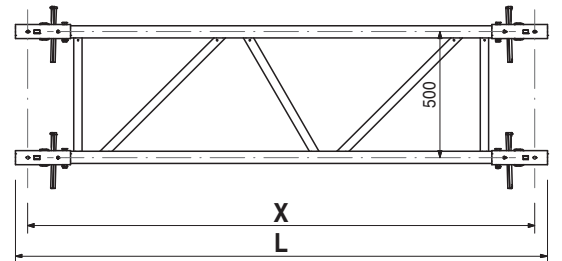
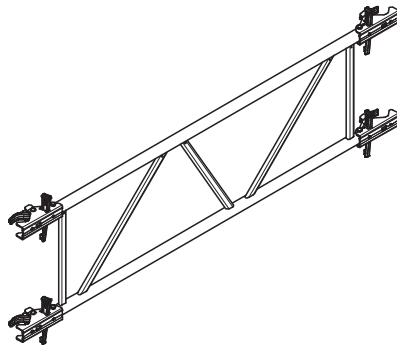

103434	33,400
103429	40,200

Pallets RP-2, galv.
Pallet RP-2 80 x 120, galv.
Pallet RP-2 80 x 150, galv.

For stacking and transporting of formwork and scaffold components.

Safety instructions

Load-bearing capacity 1.5 t.
 Follow Instructions for Use!

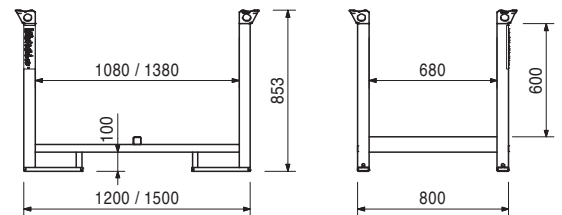
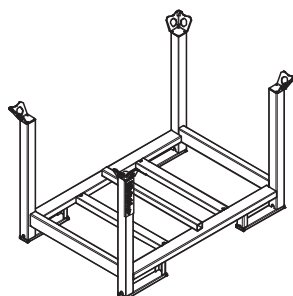



01 PERI GmbH
 Rudolf-Diesel-Strasse
 89264 Weissenhorn
 info@peri.com
 www.peri.com



02 France
 PERI S.A.S.
 77109 Meaux Cedex
 peri.sas@peri.fr
 www.peri.fr

03 Switzerland
 PERI AG
 8472 Ohringen
 info@peri.ch
 www.peri.ch

04 Spain
 PERI S.A.
 28110 Algete - Madrid
 info@peri.es
 www.peri.es

05 Belgium/Luxembourg
 N.V. PERI S.A.
 1840 Londerzeel
 info@peri.be
 www.peri.be

06 Netherlands
 PERI B.V.
 5480 AH-Schijndel
 info@peri.nl
 www.peri.nl

07 USA
 PERI Formwork Systems, Inc.
 Elkridge, MD 21075
 info@peri-usa.com
 www.peri-usa.com

08 Indonesia
 PT Beton Perkasa Wijaksana
 Jakarta 10210
 bpw@betonperkasa.com
 www.peri.com

09 Italy
 PERI S.p.A.
 20060 Basiano
 info@peri.it
 www.peri.it

10 Japan
 PERI Japan K.K.
 Tokyo 103-0015
 info@perijapan.jp
 www.perijapan.jp

11 United Kingdom/Ireland
 PERI Ltd.
 Rugby, CV23 0AN
 info@peri.ltd.uk
 www.peri.ltd.uk

12 Turkey
 PERI Kalıp ve İskeleleri
 Esenyurt / İstanbul 34510
 info@peri.com.tr
 www.peri.com.tr

13 Hungary
 PERI Kft.
 1181 Budapest
 info@peri.hu
 www.peri.hu

14 Malaysia
 PERI Formwork Malaysia
 Sdn. Bhd.
 43300 Seri Kembangan,
 Selangor Darul Ehsan
 info@perimalaysia.com
 www.perimalaysia.com

15 Singapore
 PERI ASIA Pte. Ltd
 Singapore 387355
 pha@periasia.com
 www.periasia.com

16 Austria
 PERI Ges.mbh
 3134 Nußdorf ob der Traisen
 office@peri.at
 www.peri.at

17 Czech Republic
 PERI spol. s r.o.
 252 42 Jesenice u Prahy
 info@peri.cz
 www.peri.cz

18 Denmark
 PERI Danmark A/S
 2670 Greve
 peri@peri.dk
 www.peri.dk

19 Finland
 PERI Suomi Ltd. Oy
 05460 Hyvinkää
 info@perisuomi.fi
 www.perisuomi.fi

20 Norway
 PERI Norge AS
 3036 Drammen
 info@peri.no
 www.peri.no

21 Poland
 PERI Polska Sp. z o.o.
 05-860 Płochocin
 info@peri.pl.pl
 www.peri.pl.pl

22 Sweden
 PERIform Sverige AB
 30013 Halmstad
 peri@periform.se
 www.periform.se

23 Korea
 PERI (Korea) Ltd.
 Seoul 135-080
 info@perikorea.com
 www.perikorea.com

24 Portugal
 PERIcofragens Lda
 2790-326 Queijas
 info@peri.pt
 www.peri.pt

25 Argentina
 PERI S.A.
 B1625GPA Escobar – Bs. As.
 info@peri.com.ar
 www.peri.com.ar

26 Brazil
 PERI Formas e
 Escoramentos Ltda.
 Vargem Grande Paulista
 São Paulo
 info@peribrasil.com.br
 www.peribrasil.com.br

27 Chile
 PERI Chile Ltda.
 Colina, Santiago de Chile
 peri.chile@peri.cl
 www.peri.cl

28 Romania
 PERI România SRL
 077015 Balotești
 info@peri.ro
 www.peri.ro

29 Slovenia
 PERI Slovenien
 2000 Maribor
 peri.slo@triera.net
 www.peri.com

30 Slovakia
 PERI spol. s r.o.
 903 01 Senec
 info@peri.sk
 www.peri.sk

31 Australia
 PERI Australia Pty. Ltd.
 Glendenning NSW 2761
 info@periaus.com.au
 www.periaus.com.au

32 Estonia
 PERI AS
 76406 Saku vald
 Harjumaa
 peri@peri.ee
 www.peri.ee

33 Greece
 PERI Hellas Ltd.
 194 00 Koropi
 info@perihellas.gr
 www.perihellas.gr

34 Latvia
 PERI SIA
 2118 Salaspils novads,
 Rigas rajons
 info@peri-latvija.lv
 www.peri-latvija.lv

35 United Arab Emirates
 PERI (L.L.C.)
 Dubai
 perillc@perime.com
 www.perime.com



- 36 Canada**
PERI Formwork Systems, Inc.
Bolton, ON – L7E 1K1
info@peri.ca
www.peri.ca
- 37 Lebanon**
Lebanon Representative Office
Jdeideh
lebanon@peri.de
www.peri.de
- 38 Lithuania**
PERI UAB
02300 Vilnius
info@peri.lt
www.peri.lt
- 39 Morocco**
PERI S.A.
Tanger
peri25@menara.ma
www.peri.com
- 40 Israel**
PERI Formwork
Engineering Ltd
Petach Tikva, 49002
info@peri.co.il
www.peri.co.il
- 41 Bulgaria**
PERI Bulgaria EOOD
1839 Sofia
peri.bulgaria@peri.bg
www.peri.bg
- 42 Iceland**
Armar ehf.
220 Hafnarfjörður
www.armor.is
- 43 Kazakhstan**
TOO PERI Kazakhstan
050059 Almaty
peri@peri.kz
www.peri.kz
- 44 Russian Federation**
OOO PERI
142407, Noginsk District
moscow@peri.ru
www.peri.ru
- 45 South Africa**
Wiehahn Formwork and
Scaffolding (Pty) Ltd.
7600 Stellenbosch
info@wiehahn.co.za
www.wiehahn.co.za
- 46 Ukraine**
TOW PERI Ukraina
07400 Brovary
peri@peri.ua
www.peri.ua
- 47 Egypt**
Egypt Branch Office
11361 Heliopolis / Cairo
info@peri.com.eg
www.peri.com.eg
- 48 Serbia**
PERI Oplate d.o.o.
11272 Dobanovci
office@peri.rs
www.peri.rs
- 49 Mexico**
PERI Cimbras y Andamios,
S.A. de C.V.
Estado de México,
info@peri.com.mx
www.peri.com.mx
- 50 Azerbaijan**
PERI Kalıp ve İskeleleri
Baku
peribaku@peri.com.tr
www.peri.com.tr
- 51 Turkmenistan**
PERI Kalıp ve İskeleleri
Aşgabat
ahmet.kadioglu@peri.com.tr
www.peri.com.tr
- 52 Belorussia**
PERI Belarus
220030 Minsk
info@peri.by
www.peri.com
- 53 Croatia**
PERI oplate i skele d.o.o.
10 250 Donji Stupnik/
Zagreb
info@peri.com.hr
www.peri.com.hr
- 54 Iran**
PERI GmbH
Iran Branch Office
Tehran
info@peri.ir
www.peri.ir
- 55 India**
PERI (India) Pvt Ltd
Mumbai – 400064
info@peri.in
www.peri.in
- 56 Jordan**
PERI GmbH - Jordan
11947 Amman
jordan@peri.com
www.peri.com
- 57 Kuwait**
PERI Kuwait
13011 Kuwait
kuwait@peri.com
www.peri.com
- 58 Saudi Arabia**
PERI Engineering
Division of Jamjoom
Consult Saudi Arabia
21463 Jeddah
info@peri.com.sa
www.peri.com.sa
- 59 Qatar**
PERI Qatar LLC
P.O.Box: 31295 - Doha
info@periqatar.com
www.periqatar.com
- 60 Algeria**
Société PERI S.A.S.
Kouba - Alger
peri.alger@peri.fr
www.peri.fr
- 61 Albania**
PERI Sh.p.k.
Tirane
erti.hasanaj@peri.com.tr
www.peri.com.tr
- 62 Peru**
PERI Peruana SAC
Villa El Salvador, Lima
contacto@peri.com.pe
www.peri.com.pe
- 63 Panama**
PERI Panama Inc.
0832-00155 Panama City
info@peri.com.pa
www.peri.com.pa
- 64 Angola**
PERIcofragens, Lda.
Luanda
renato.portugal@peri.pt
www.peri.pt
- 65 Nigeria**
Heights Access Nigeria Ltd.
Victoria Island, Lagos
info@heightsaccessng.com
www.heightsaccessng.com
- 66 Oman**
PERI (L.L.C.)
Muscat
perimct@perime.com
www.perime.com

The optimal System for every Project and every Requirements



Wall Formwork



Column Formwork



Slab Formwork



Climbing Systems



Tunnel Formwork



Bridge Formwork



Shoring Systems



Construction Scaffold



Facade Scaffold



Industrial Scaffold



Access



Protection Scaffold



System-Independent Accessories



Services



PERI GmbH
Formwork Scaffolding Engineering
 P.O. Box 1264
 89259 Weissenhorn
 Germany
 Tel. +49 (0)7309.950-0
 Fax +49 (0)7309.951-0
 info@peri.com
 www.peri.com